

2000 PSI BVSR

Product features:

Pipe threaded in accordance with ASME B2.1, BS21
 Blow-out proof stem design
 2000 W.O.G.
 Carbon steel body
 Female NPT
 NACE MR-01-75 as a standard

Parts

Body
 End Plug
 Big Seat
 Thrust Washer
 Gland
 Gland Nut
 Stem
 Handle
 Seat
 Ball
 Stem Packing

Standard Material

Carbon Steel
 Carbon Steel
 PTFE
 PTFE
 304 SS
 304 SS
 316SS
 Steel
 RTFE
 316SS
 PTFE

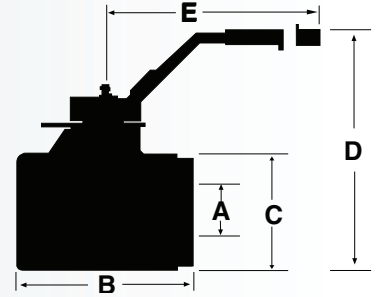

Size	A	B	C	D	E	WT
1/4	0.35	1.70	0.815	1.27	3.18	0.30
3/8	0.35	1.70	0.815	1.27	3.18	0.30
1/2	0.35	2.76	1.500	2.49	4.33	0.25
3/4	0.49	2.68	1.960	2.44	4.33	0.25
1	0.59	3.54	1.680	2.63	4.76	1.75
1 1/4	0.79	3.78	2.275	3.25	5.75	2.50
1 1/2	0.98	4.06	2.280	3.25	5.75	3.75
2	1.26	4.68	2.745	3.44	5.98	5.0